



# SP-6

Sutera USA LLC - 55 Commerce Center, Greenville SC. 29615 USA  
 Sutera Canada Inc. - 700 Rupert Street, Waterloo ON. N2V 2B5 CANADA

Description	Designed to safely and securely contain waste in-ground, where it is kept cool and reduces odors. The containment is fire proof, animal proof and impact resistant, by utilizing concrete and steel construction. Serviced by vertical lift crane truck.
Materials	<p>Plastic Lid / Steel Frame</p> <ul style="list-style-type: none"> <li>- 0.250" heavy wall LLDPE (Linear Low Density Polyethylene)</li> <li>- Carbon steel frame</li> </ul> <p>Precast Concrete Containment Well:</p> <ul style="list-style-type: none"> <li>- High strength, steel reinforced concrete with high sulfate resistant cement</li> <li>- Overall mass exceeds the natural forces of hydrostatic pressure (will not float)</li> <li>- All precast risers and bases contain 2 swift lift hook anchors for lifting</li> </ul> <p>Reusable Containment Bag</p> <ul style="list-style-type: none"> <li>- 18 oz. PVC coated polyester bag</li> <li>- Heavy duty bag hardware for cinching the bag closed</li> </ul>
Technical Data	<p>Dimensions:</p> <p>Large Steel Lid = 76.25" dia. (1937 mm), Convex Curve = +5.0" (127 mm)          Steel Access Lid Opening = 23" dia. (584 mm)          Access height above finished grade = 42" (1067 mm)          Precast Concrete Inside Dia. = 60" (1524 mm), Outside Dia. = 72" (1829 mm)          Precast Concrete Inside Depth = 96" (2438 mm), Overall Height = 104" (2642 mm)</p> <p>Weights:</p> <p>Plastic Lid = 60 lbs (27 kg), Steel Frame = 150 lbs (68 kg)          Precast Concrete: Monobase = 8173 lbs (3707 kg), Riser = 5179 lbs (2349 kg)</p> <p>Volume:</p> <p>Containment Capacity = 5.82 cu.yds (4450 liters)</p>
Maintenance Instructions	<p>Spray White Lithium Grease to the following locations every three months, more frequently in colder weather.</p> <ul style="list-style-type: none"> <li>- key hole of locking mechanism</li> <li>- all moving components(hinges, pivot points)</li> </ul> <p>Note: White Lithium Grease does not freeze in cold temperatures</p> <p>Entire Exterior of unit should be kept clean with soap and water, clean as required.</p>

For more information about this product visit [www.sutera-inground.com](http://www.sutera-inground.com) or email [contact@sutera-inground.com](mailto:contact@sutera-inground.com)

Sutera USA LLC - 55 Commerce Center, Greenville SC. 29615 USA  
Sutera Canada Inc. - 700 Rupert Street, Waterloo ON. N2V 2B5 CANADA

Top View

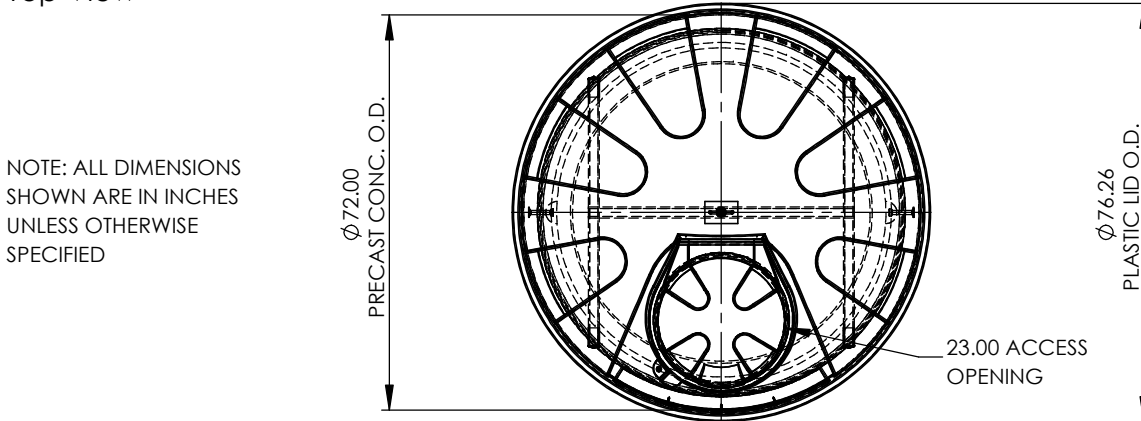

Front View

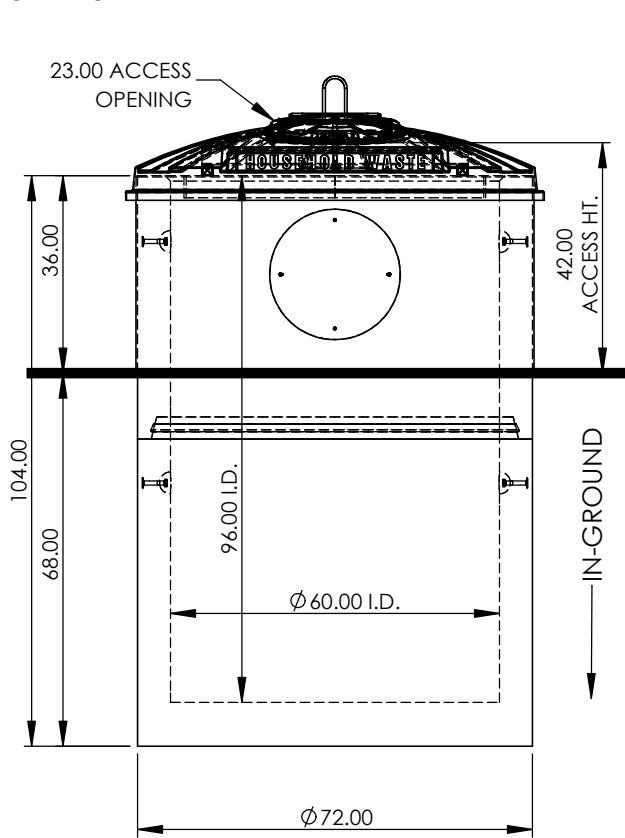

Section View

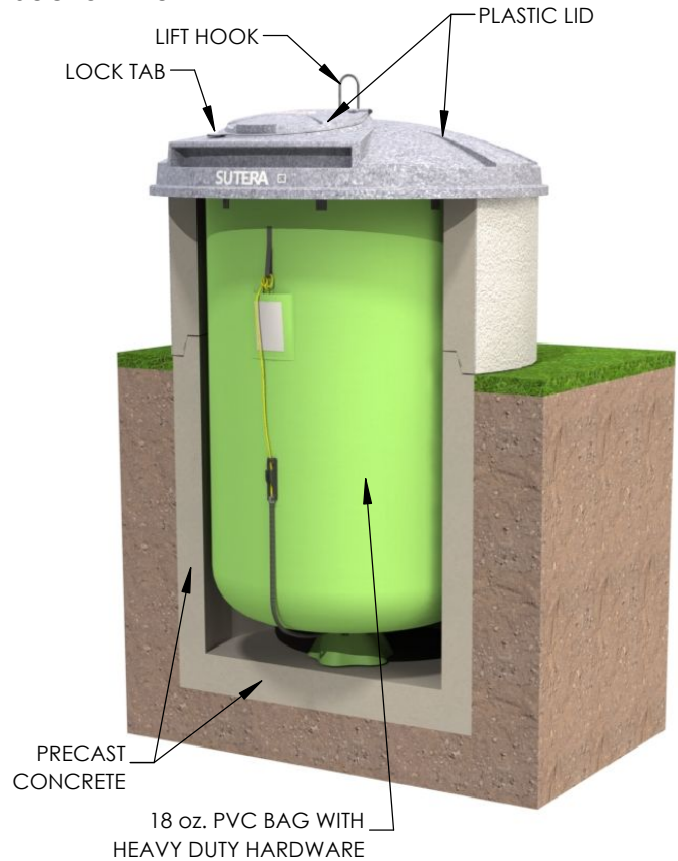

For more information about this product visit [www.sutera-inground.com](http://www.sutera-inground.com) or email [contact@sutera-inground.com](mailto:contact@sutera-inground.com)